

# Key

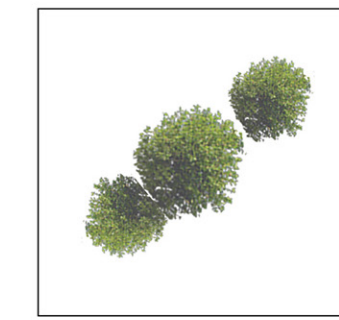

existing trees to be retained  
(shown indicatively only)

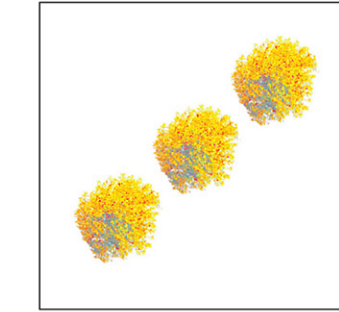

PROPOSED SEMI MATURE TREE  
*Sorbus aucuparia* (Rowan)  
4x tr. 20-25cm girth, 4.5-5.0m high,  
min. 2m high clear stem, RB

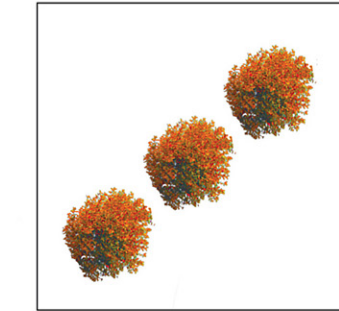

PROPOSED SEMI MATURE TREE  
*Corylus colurna* (Turkish hazel)  
4x tr. 20-25cm girth, 4.5-5.0m high,  
min. 2m high clear stem, RB

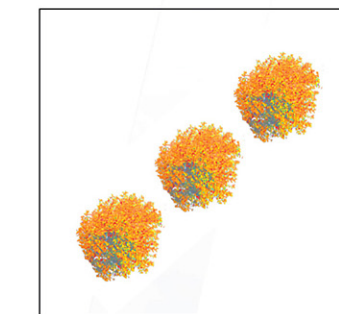

PROPOSED SEMI MATURE TREE  
*Carpinus betulus* 'Fastigiata' (Hornbeam)  
4x tr. 20-25cm girth, 4.5-5.0m high,  
min. 2m high clear stem, RB

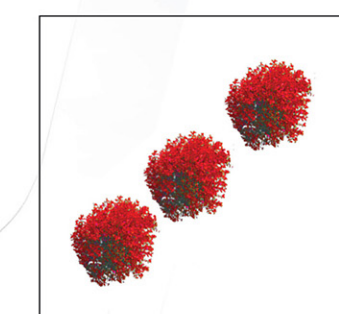

PROPOSED SEMI MATURE TREE  
*Tilia cordata* 'Greenspire' (Lime)  
4x tr. 20-25cm girth, 4.5-5.0m high,  
min. 2m high clear stem, RB

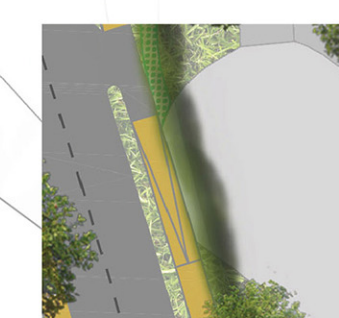

PROPOSED HEDGE PLANTING

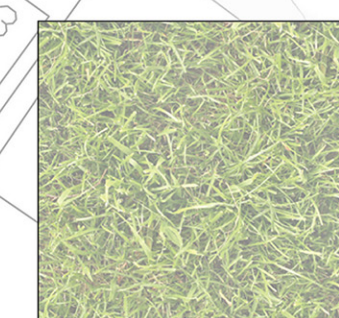

Grass



 *Sorbus aucuparia* (Rowan)

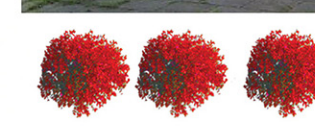

 *Tilia cordata* 'Greenspire'



 *Carpinus betulus* 'Fastigiata'



 *Corylus colurna*