

**SOUTH DUBLIN COUNTY COUNCIL
COMHAIRLE CHONTAE ATHA CLIATH THEAS**



**COMPULSORY PURCHASE ORDER UNDER SECTION 76 OF AND THE THIRD SCHEDULE TO THE HOUSING ACT, 1966, AS
EXTENDED BY SECTION 10 OF THE LOCAL GOVERNMENT (NO.2) ACT, 1960, AND AMENDED BY SECTION 213 OF THE
PLANNING AND DEVELOPMENT ACT, 2000.**

LOCAL GOVERNMENT ACTS, 1925 - 2003

ROADS ACTS 1993 - 2001

PLANNING AND DEVELOPMENT ACTS 2000 - 2002

**SECTION 10 OF THE LOCAL GOVERNMENT (IRELAND) ACT, 1898, AS AMENDED BY SECTION 11 OF THE LOCAL
GOVERNMENT (NO.2) ACT, 1960, AND SECTION 213 OF THE PLANNING AND DEVELOPMENT ACTS, 2000 - 2002**

SECTION 11 OF THE LOCAL GOVERNMENT ACT 2001

WHEREAS in pursuance of Section 10 of the Local Government (No. 2) Act, 1960, as substituted by Section 86 of the Housing Act, 1966 as amended by Section 6 and the Second Schedule to the Roads Act, 1993 and as amended by the Planning and Development Act, 2000 and the Local Government Act, 2001, South Dublin County Council (hereinafter referred to as "the local authority") have decided to effect the acquisition of the land to which this order relates under the Housing Act, 1966 as amended and extended:

NOW THEREFORE it is hereby ordered that -

1. Subject to the provisions of this order, the local authority is hereby authorised to
 - a) acquire compulsorily for the purposes of the construction of a road improvement scheme, and all ancillary works associated therewith, from the townland of Ballybane to the townlands of Milltown and Grange, commencing at the Nangor Road west of Kilcarberry roundabout and concluding at the R120 Lucan/Newcastle Road west of the Nangor Road, County Dublin and traversing the townlands of Ballybane, Milltown, Kilcarberry, Clutterland and Grange, all in the County of Dublin, the lands described in Part I of the Schedule hereto which land is shown on the maps **marked “South Dublin County Council Compulsory Purchase (Nangor Road Improvement Scheme) Order, 2006”** (Drawings No. MDT0161DP0001 to MDT0161DP0003) and sealed with the seal of the local authority and deposited at the offices of the local authority (hereafter referred to as “The Deposited Maps”), and
 - b) to extinguish the public rights of way described in the Part II of the Second Schedule hereto by order made by them after the acquisition of the land, where the said public right of way is over the land so acquired or any part thereof, or over land adjacent to or associated with the land so acquired or any part thereof.

2. The land described in Part 1 of the Schedule hereto and coloured grey on the said map is land other than land consisting of a house or houses unfit for human habitation and not capable of being rendered fit for human habitation at reasonable expense.

3. Subject to any necessary adaptations, the provisions of -
 - (a) the Lands Clauses Acts (except sections 127 to 132 of the Lands Clauses Consolidation Act, 1845, and article 20 of the Second Schedule to the Housing of the Working Classes Act, 1890), and
 - (b) the Acquisition of Land (Assessment of Compensation) Act, 1919, as amended by the Acquisition of Land (Reference Committee) Act, 1925, the Property Values (Arbitrations and Appeals) Act, 1960, and the Local Government (Planning and Development) Act, 1963 (as applied by section 265(3) of the Planning and Development Act, 2000),as modified by the Third Schedule to the Housing Act, 1966 are hereby incorporated in this order and the provisions of those Acts shall apply accordingly.

4. This order may be cited as the “South Dublin County Council Compulsory Purchase (Nangor Road Improvement Scheme) Order 2006”.

Schedule Part I

Land other than land consisting of a house or houses unfit for human habitation and not capable of being rendered fit for human habitation at reasonable expense.

Number on Map Deposited at the offices of the Local Authority	Quantity, Description and Situation of the Land					Owner(s) or Reputed Owner(s)	Lessee(s) or Reputed Lessee(s)	Occupier(s) (Except tenants for a month or a less period than a month)
	Quantity Sq. Metres	OS Map Reference	Townland	District Electoral Division	Description of property			
100a.101	640	3325 - 04 3325 - 09	Grange	Newcastle	Development Land	South Dublin County Council, County Hall, Tallaght, Dublin 24.	None	South Dublin County Council, County Hall, Tallaght, Dublin 24.
100a.102	11324	3325 - 04 3325 - 09	Grange	Clondalkin-Dunawley	Development Land	South Dublin County Council, County Hall, Tallaght, Dublin 24.	None	South Dublin County Council, County Hall, Tallaght, Dublin 24.
100a.103	898	3325 - 09	Clutterland	Newcastle	Development Land	South Dublin County Council, County Hall, Tallaght, Dublin 24.	None	South Dublin County Council, County Hall, Tallaght, Dublin 24.
100b.101	3637	3325 - 04 3325 - 09	Grange & Clutterland	Newcastle & Clondalkin-Dunawley	Public Road	South Dublin County Council, County Hall, Tallaght, Dublin 24.	None	South Dublin County Council, County Hall, Tallaght, Dublin 24.
100c.101	22993	3325 - 09	Ballybane, Milltown & Clutterland	Clondalkin-Dunawley	Development Land	South Dublin County Council, County Hall, Tallaght, Dublin 24.	None	South Dublin County Council, County Hall, Tallaght, Dublin 24.
100c.102	1458	3325 - 09	Milltown	Newcastle	Agricultural Land	South Dublin County Council, County Hall, Tallaght, Dublin 24.	None	South Dublin County Council, County Hall, Tallaght, Dublin 24.
100c.103	424	3325 - 09	Clutterland	Clondalkin-Dunawley	Development Land	South Dublin County Council, County Hall, Tallaght, Dublin 24.	None	South Dublin County Council, County Hall, Tallaght, Dublin 24.
100c.104	684	3325 - 09	Milltown	Clondalkin-Village	Development Land	South Dublin County Council, County Hall, Tallaght, Dublin 24.	None	South Dublin County Council, County Hall, Tallaght, Dublin 24.

Number on Map Deposited at the offices of the Local Authority	Quantity, Description and Situation of the Land					Owner(s) or Reputed Owner(s)	Lessee(s) or Reputed Lessee(s)	Occupier(s) (Except tenants for a month or a less period than a month)
	Quantity Sq. Metres	OS Map Reference	Townland	District Electoral Division	Description of property			
100d.101	8972	3325 - 09	Ballybane, Milltown & Clutterland	Newcastle, Clondalkin-Dunawley & Clondalkin-Village	Public Road	South Dublin County Council, County Hall, Tallaght, Dublin 24.	None	South Dublin County Council, County Hall, Tallaght, Dublin 24.
100e.101	5403	3325 - 10	Ballybane	Clondalkin-Dunawley	Development Land	South Dublin County Council, County Hall, Tallaght, Dublin 24.	None	South Dublin County Council, County Hall, Tallaght, Dublin 24.
100e.102	5181	3325 - 09 3325 - 10	Ballybane	Clondalkin-Village	Development Land	South Dublin County Council, County Hall, Tallaght, Dublin 24.	None	South Dublin County Council, County Hall, Tallaght, Dublin 24.
100f.101	7268	3325 - 09 3325 - 10	Ballybane	Clondalkin-Dunawley & Clondalkin-Village	Public Road	South Dublin County Council, County Hall, Tallaght, Dublin 24.	None	South Dublin County Council, County Hall, Tallaght, Dublin 24.
101b.101	593	3325 - 09	Grange	Newcastle	Public Road	Robert Beattie, The Grange, Lucan, County Dublin. Leslie Beattie, The Grange, Lucan, County Dublin.	None	Robert Beattie, The Grange, Lucan, County Dublin. Leslie Beattie, The Grange, Lucan, County Dublin. South Dublin County Council, County Hall, Tallaght, Dublin 24.
103a.101	409	3325 - 09	Milltown	Newcastle	Agricultural Land	Peadar Healy, 29, Butterfield Avenue, Dublin 14.	None	Peadar Healy, 29, Butterfield Avenue, Dublin 14.
103b.101	996	3325 - 09	Milltown	Newcastle	Public Road	Peadar Healy, 29, Butterfield Avenue, Dublin 14.	None	Peadar Healy, 29, Butterfield Avenue, Dublin 14. South Dublin County Council, County Hall, Tallaght, Dublin 24.

Number on Map Deposited at the offices of the Local Authority	Quantity, Description and Situation of the Land					Owner(s) or Reputed Owner(s)	Lessee(s) or Reputed Lessee(s)	Occupier(s) (Except tenants for a month or a less period than a month)
	Quantity Sq. Metres	OS Map Reference	Townland	District Electoral Division	Description of property			
104b.101	623	3325 - 09 3325 - 10	Ballybane	Clondalkin-Dunawley	Public Road	Martin McNulty, Ballybane, Clondalkin, Dublin 22.	None	Martin McNulty, Ballybane, Clondalkin, Dublin 22. South Dublin County Council, County Hall, Tallaght, Dublin 24.
105b.101	365	3325 - 10	Ballybane	Clondalkin-Village	Public Road	Phyllis Carey, Ballybane, Clondalkin, Dublin 22.	Barney Lee, Ballybane Builders Providers, Ballybane, Nangor Road, Clondalkin, Dublin 22.	Phyllis Carey, Ballybane, Clondalkin, Dublin 22. Barney Lee, Ballybane Builders Providers, Ballybane, Nangor Road, Clondalkin, Dublin 22. Michael Carey, Ballybane, Clondalkin, Dublin 22. Castle Cars, Ballybane, Clondalkin, Dublin 22. Tony Boland Autolink, Grange Castle, Nangor Road, Dublin 22. Jerry Murtagh, Ballybane, Clondalkin, Dublin 22. South Dublin County Council, County Hall, Tallaght, Dublin 24.

Number on Map Deposited at the offices of the Local Authority	Quantity, Description and Situation of the Land					Owner(s) or Reputed Owner(s)	Lessee(s) or Reputed Lessee(s)	Occupier(s) (Except tenants for a month or a less period than a month)
	Quantity Sq. Metres	OS Map Reference	Townland	District Electoral Division	Description of property			
106a.101	66	3325 - 10	Ballybane	Clondalkin-Dunawley	Stream	<p>Elizabeth McDonnell, Ballybane House, Clondalkin, Dublin 22.</p> <p>John O'Sullivan, Ballybane House, Clondalkin, Dublin 22.</p> <p>Lorraine O'Sullivan, Ballybane House, Clondalkin, Dublin 22.</p>	None	<p>Elizabeth McDonnell, Ballybane House, Clondalkin, Dublin 22.</p> <p>John O'Sullivan, Ballybane House, Clondalkin, Dublin 22.</p> <p>Lorraine O'Sullivan, Ballybane House, Clondalkin, Dublin 22.</p> <p>South Dublin County Council, County Hall, Tallaght, Dublin 24.</p>
106b.101	226	3325 - 10	Ballybane	Clondalkin-Dunawley	Public Road	<p>Elizabeth McDonnell, Ballybane House, Clondalkin, Dublin 22.</p> <p>John O'Sullivan, Ballybane House, Clondalkin, Dublin 22.</p> <p>Lorraine O'Sullivan, Ballybane House, Clondalkin, Dublin 22.</p>	None	<p>Elizabeth McDonnell, Ballybane House, Clondalkin, Dublin 22.</p> <p>John O'Sullivan, Ballybane House, Clondalkin, Dublin 22.</p> <p>Lorraine O'Sullivan, Ballybane House, Clondalkin, Dublin 22.</p> <p>South Dublin County Council, County Hall, Tallaght, Dublin 24.</p>

Number on Map Deposited at the offices of the Local Authority	Quantity, Description and Situation of the Land					Owner(s) or Reputed Owner(s)	Lessee(s) or Reputed Lessee(s)	Occupier(s) (Except tenants for a month or a less period than a month)
	Quantity Sq. Metres	OS Map Reference	Townland	District Electoral Division	Description of property			
107b.101	773	3325 - 10	Ballybane	Clondalkin-Village	Public Road	John Patrick O'Connor, 166, Castle Park, Clondalkin, Dublin 22.	None	John Patrick O'Connor, 166, Castle Park, Clondalkin, Dublin 22. South Dublin County Council, County Hall, Tallaght, Dublin 24.
109b.101	733	3325 - 10	Ballybane	Clondalkin-Village	Public Road	Daniel Cahillane, 142, Dowland Road, Crumlin, Dublin 12.	None	Daniel Cahillane, 142, Dowland Road, Crumlin, Dublin 12. South Dublin County Council, County Hall, Tallaght, Dublin 24.
110b.101	295	3325 - 09	Milltown	Newcastle	Public Road	Joseph Patton, 32, Bettyglen, Raheny, Dublin 5. Breege Patton, 32, Bettyglen, Raheny, Dublin 5.	None	Joseph Patton, 32, Bettyglen, Raheny, Dublin 5. Breege Patton, 32, Bettyglen, Raheny, Dublin 5. South Dublin County Council, County Hall, Tallaght, Dublin 24.

Number on Map Deposited at the offices of the Local Authority	Quantity, Description and Situation of the Land					Owner(s) or Reputed Owner(s)	Lessee(s) or Reputed Lessee(s)	Occupier(s) (Except tenants for a month or a less period than a month)
	Quantity Sq. Metres	OS Map Reference	Townland	District Electoral Division	Description of property			
111b.101	963	3325 - 10	Ballybane	Clondalkin-Dunawley	Public Road	Laurentrade Builders Limited, 31, Waterloo Road, Ballsbridge, Dublin 4.	George Tracey, 9, Kerry Mount Green, Foxrock, Dublin 18.	Laurentrade Builders Limited, 31, Waterloo Road, Ballsbridge, Dublin 4. George Tracey, 9, Kerry Mount Green, Foxrock, Dublin 18. South Dublin County Council, County Hall, Tallaght, Dublin 24.
112b.101	415	3325 - 10	Ballybane	Clondalkin-Dunawley	Public Road	Paddy Shovlin, 10, Fleet Street, Dublin 2.	None	Paddy Shovlin, 10, Fleet Street, Dublin 2. South Dublin County Council, County Hall, Tallaght, Dublin 24.
113a.101	941	3325 - 10	Ballybane	Clondalkin-Dunawley	Development Land	George Tracey, 9, Kerry Mount Green, Foxrock, Dublin 18.	TK Ltd. (Trading as C&C Wholesale Ltd.), Kilcarberry Business Park, Nangor Road, Clondalkin, Dublin 22.	George Tracey, 9, Kerry Mount Green, Foxrock, Dublin 18. TK Ltd. (Trading as C&C Wholesale Ltd.), Kilcarberry Business Park, Nangor Road, Clondalkin, Dublin 22.
113b.101	465	3325 - 10	Ballybane	Clondalkin-Dunawley	Public Road	George Tracey, 9, Kerry Mount Green, Foxrock, Dublin 18.	None	George Tracey, 9, Kerry Mount Green, Foxrock, Dublin 18. South Dublin County Council, County Hall, Tallaght, Dublin 24.

Number on Map Deposited at the offices of the Local Authority	Quantity, Description and Situation of the Land					Owner(s) or Reputed Owner(s)	Lessee(s) or Reputed Lessee(s)	Occupier(s) (Except tenants for a month or a less period than a month)
	Quantity Sq. Metres	OS Map Reference	Townland	District Electoral Division	Description of property			
114a.101	530	3325 - 09	Kilmactalway	Newcastle	Agricultural Land	Billy Corrigan, Castlebaggot, Clondalkin, Dublin 22.	None	Billy Corrigan, Castlebaggot, Clondalkin, Dublin 22.
114b.101	1248	3325 - 09	Kilmactalway	Newcastle	Public Road	Billy Corrigan, Castlebaggot, Clondalkin, Dublin 22.	None	Billy Corrigan, Castlebaggot, Clondalkin, Dublin 22. South Dublin County Council, County Hall, Tallaght, Dublin 24.
115b.101	593	3325 - 09	Milltown	Newcastle	Public Road	Nicholas Joseph Walsh, Hynestown House, Celbridge, County Kildare.	None	Nicholas Joseph Walsh, Hynestown House, Celbridge, County Kildare. South Dublin County Council, County Hall, Tallaght, Dublin 24.

Schedule Part II

1. That section of the Regional Secondary Road R120, Lucan / Newcastle Road, in the Townlands of Clutterland and Grange and in the District Electoral Divisions of Clondalkin-Dunawley and Newcastle all in the County of Dublin and between the lines A-A and B-B, shown on the Drawing No. MDT0161DP0001 Sheet 1 of 3 of the deposited maps.
2. That section of the Regional Road R134, Nangor Road, in the Townlands of Milltown, Kilmactalway and Clutterland and in the District Electoral Divisions of Clondalkin-Dunawley and Newcastle, all in the County of Dublin and between the lines C-C and D-D, shown on the Drawing No. MDT0161DP0002 Sheet 2 of 3 of the deposited maps.
3. That section of the Regional Road R134, Nangor Road, in the Townlands of Ballybane and Milltown and in the District Electoral Divisions of Clondalkin-Dunawley and Clondalkin-Village, all in the County of Dublin and between the lines E-E and F-F, shown on the Drawing No. MDT0161DP0002 Sheet 2 of 3 of the deposited maps.
4. That section of the Right of Way, in the Townland of Ballybane and in the District Electoral Division of Clondalkin-Dunawley and Clondalkin-Village all in the County of Dublin and between the lines Y-Y and Z-Z, shown on the Drawings No. MDT0161DP0003 Sheet 3 of 3 of the deposited maps.

The official seal of the Local Authority was affixed hereto this day of , 2006 in the presence of: -

DIRECTOR OF ECONOMIC DEVELOPMENT

~~MAYOR/DEPUTY MAYOR/~~
NOMINATED EMPLOYEE OF SOUTH DUBLIN COUNTY COUNCIL

COUNTY MANAGER

DEPOSIT MAPS

Key to Plot Numbers
XXXn.YZZ
 XXX : Owner Number or Owner Group Number
 n : Plot Type (a,c or e are Private Land Plots)
 (b,d or f are Public Road Plots)
 Y : Schedule Number
 ZZ : Unique Plot Number

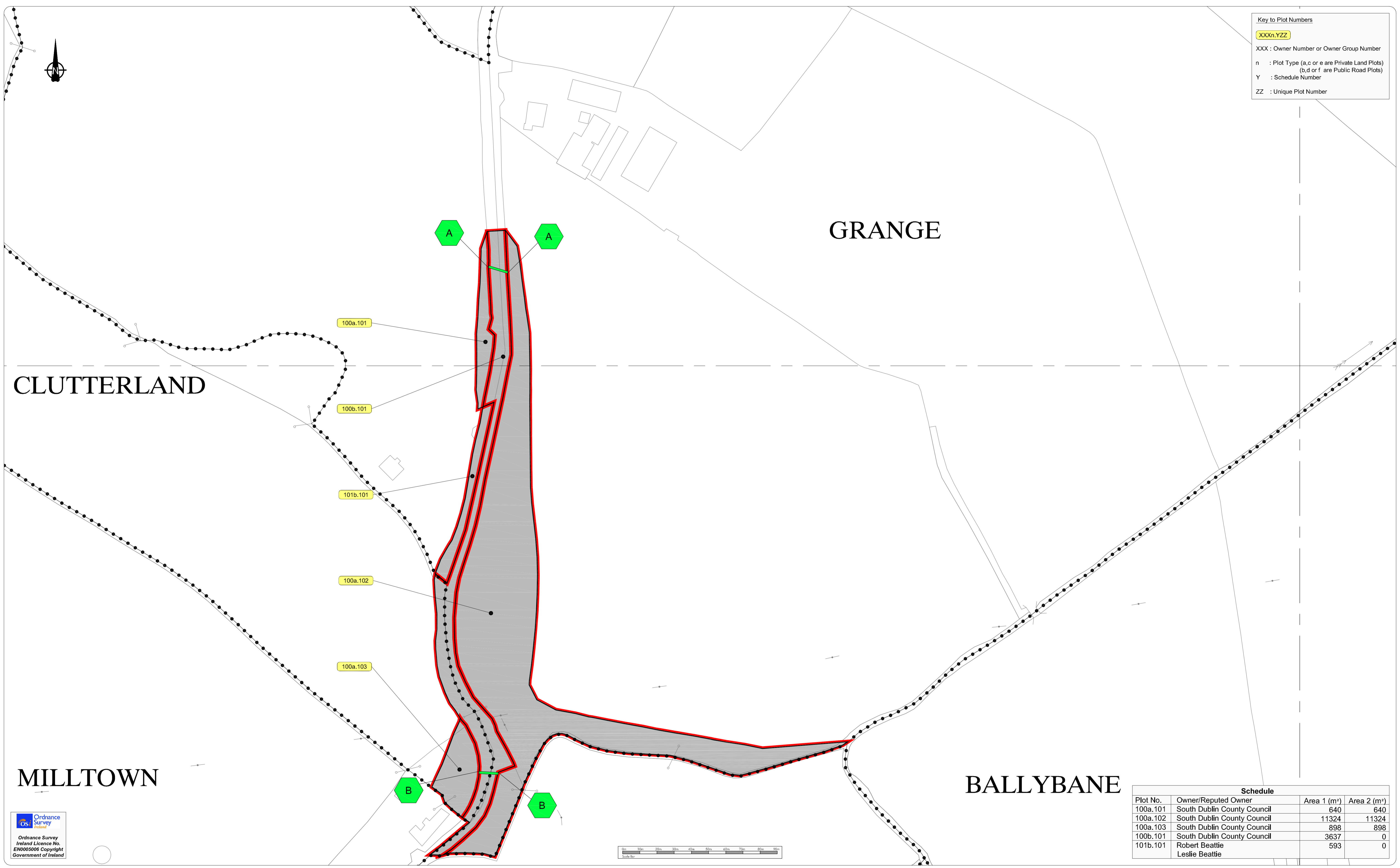

Schedule			
Plot No.	Owner/Reputed Owner	Area 1 (m ²)	Area 2 (m ²)
100a.101	South Dublin County Council	640	640
100a.102	South Dublin County Council	11324	11324
100a.103	South Dublin County Council	898	898
100b.101	South Dublin County Council	3637	0
101b.101	Robert Beattie Leslie Beattie	593	0

Ordnance Survey
 Ireland Licence No.
 EN0005006 Copyright
 Government of Ireland

COMHAIRLE CHONTAE ÁTHA CLIATH THEAS
SOUTH DUBLIN COUNTY COUNCIL
 ROADS AND TRAFFIC DEPARTMENT,
 COUNTY HALL,
 TALLAGHT,
 DUBLIN 24.

F.G. COFFEY B.E., C. Eng., F.I.E.I.
 Director of Transportation and County Engineer
 J.F. McLoughlin B.E., C. Eng., F.I.E.I.
 Senior Engineer Road Design and Construction

Mayor / Deputy Mayor /
 Nominated Employee
 County Manager
 Director of
 Economic Development
 Director of Transportation
 & County Engineer
 Director of Planning

SOUTH DUBLIN COUNTY COUNCIL
COMPULSORY PURCHASE
 (Nangor Road Improvement Scheme)
ORDER 2006

DATE November 2004
 SCALE 1:1000
 DRAWN BY RPS-MCOS-JBR
 CHECKED BY RPS-MCOS-PJM
 APPROVED BY

O.S. MAP REFERENCE
 3325 - 04, 3325 - 05
 3325 - 09, 3325 - 10
 DRAWING NO.
MDT0161DP0001
 Sheet 1 of 3



Key to Plot Numbers
 XXXn.YZZ
 XXX : Owner Number or Owner Group Number
 n : Plot Type (a,c or e are Private Land Plots)
 (b,d or f are Public Road Plots)
 Y : Schedule Number
 ZZ : Unique Plot Number

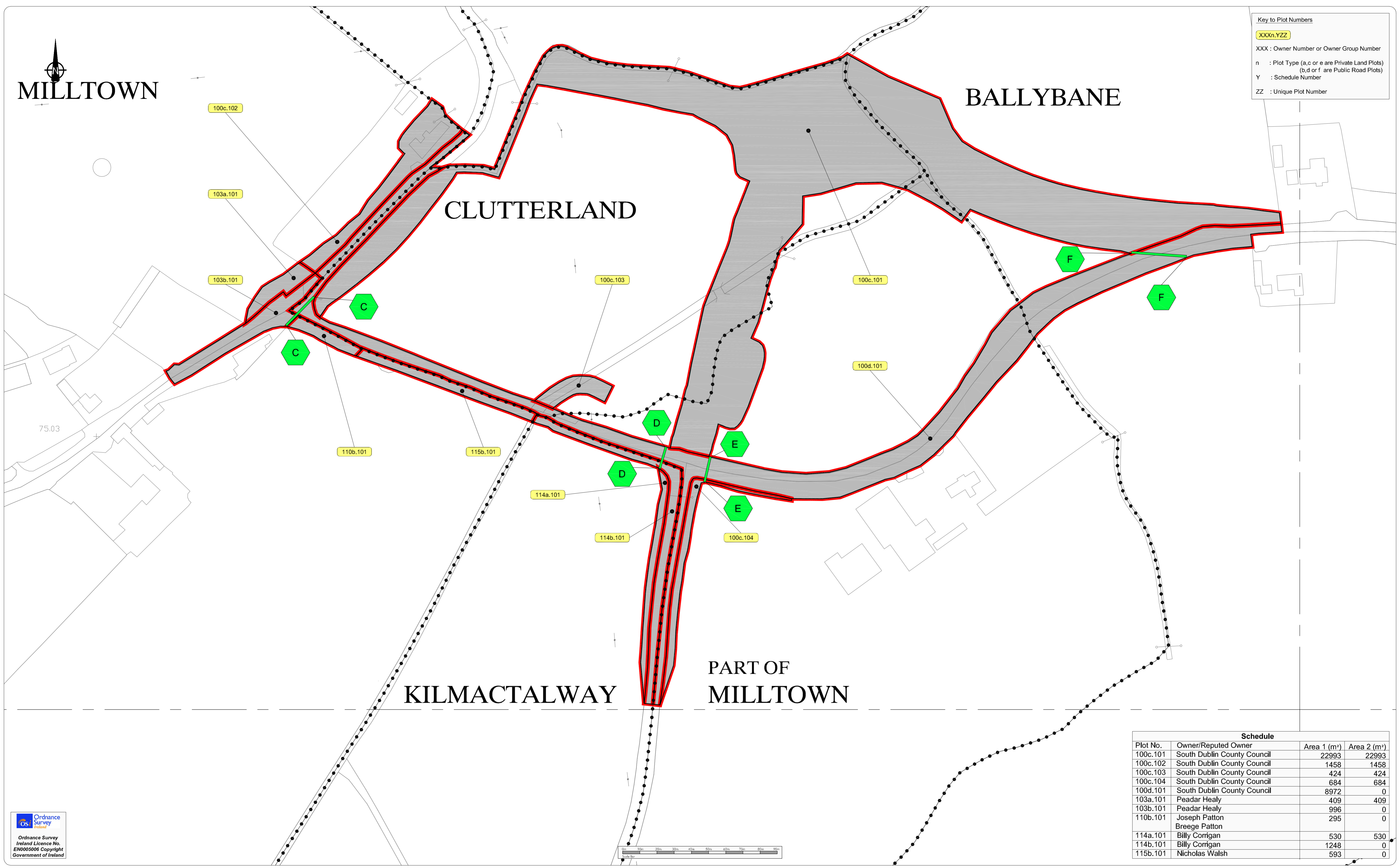

Schedule			
Plot No.	Owner/Reputed Owner	Area 1 (m ²)	Area 2 (m ²)
100c.101	South Dublin County Council	22993	22993
100c.102	South Dublin County Council	1458	1458
100c.103	South Dublin County Council	424	424
100c.104	South Dublin County Council	684	684
100d.101	South Dublin County Council	8972	0
103a.101	Peadar Healy	409	409
103b.101	Peadar Healy	996	0
110b.101	Joseph Patton Breege Patton	295	0
114a.101	Billy Corrigan	530	530
114b.101	Billy Corrigan	1248	0
115b.101	Nicholas Walsh	593	0



COMHAIRLE CHONTAE ÁTHA CLIATH THEAS
SOUTH DUBLIN COUNTY COUNCIL
 ROADS AND TRAFFIC DEPARTMENT,
 COUNTY HALL,
 TALLAGHT,
 DUBLIN 24.

F.G. COFFEY B.E., C. Eng., F.I.E.I.
 Director of Transportation and County Engineer

 J.F. McLoughlin B.E., C. Eng., F.I.E.I.
 Senior Engineer Road Design and Construction

Mayor / Deputy Mayor /
 Nominated Employee
 County Manager
 Director of
 Economic Development
 Director of Transportation
 & County Engineer
 Director of Planning

SOUTH DUBLIN COUNTY COUNCIL
COMPULSORY PURCHASE

 (Nangor Road Improvement Scheme)
ORDER 2006

DATE November 2004
 SCALE 1:1000
 DRAWN BY RPS-MCOS-JBR
 CHECKED BY RPS-MCOS-PJM
 APPROVED BY

O.S. MAP REFERENCE
 3325 - 09, 3325 - 10
 3325 - 14, 3325 - 15
 DRAWING NO.
MDT0161DP0002
 Sheet 2 of 3

BALLYBANE

Key to Plot Numbers
XXXn.YZZ
 XXX : Owner Number or Owner Group Number
 n : Plot Type (a,c or e are Private Land Plots
 (b,d or f are Public Road Plots)
 Y : Schedule Number
 ZZ : Unique Plot Number

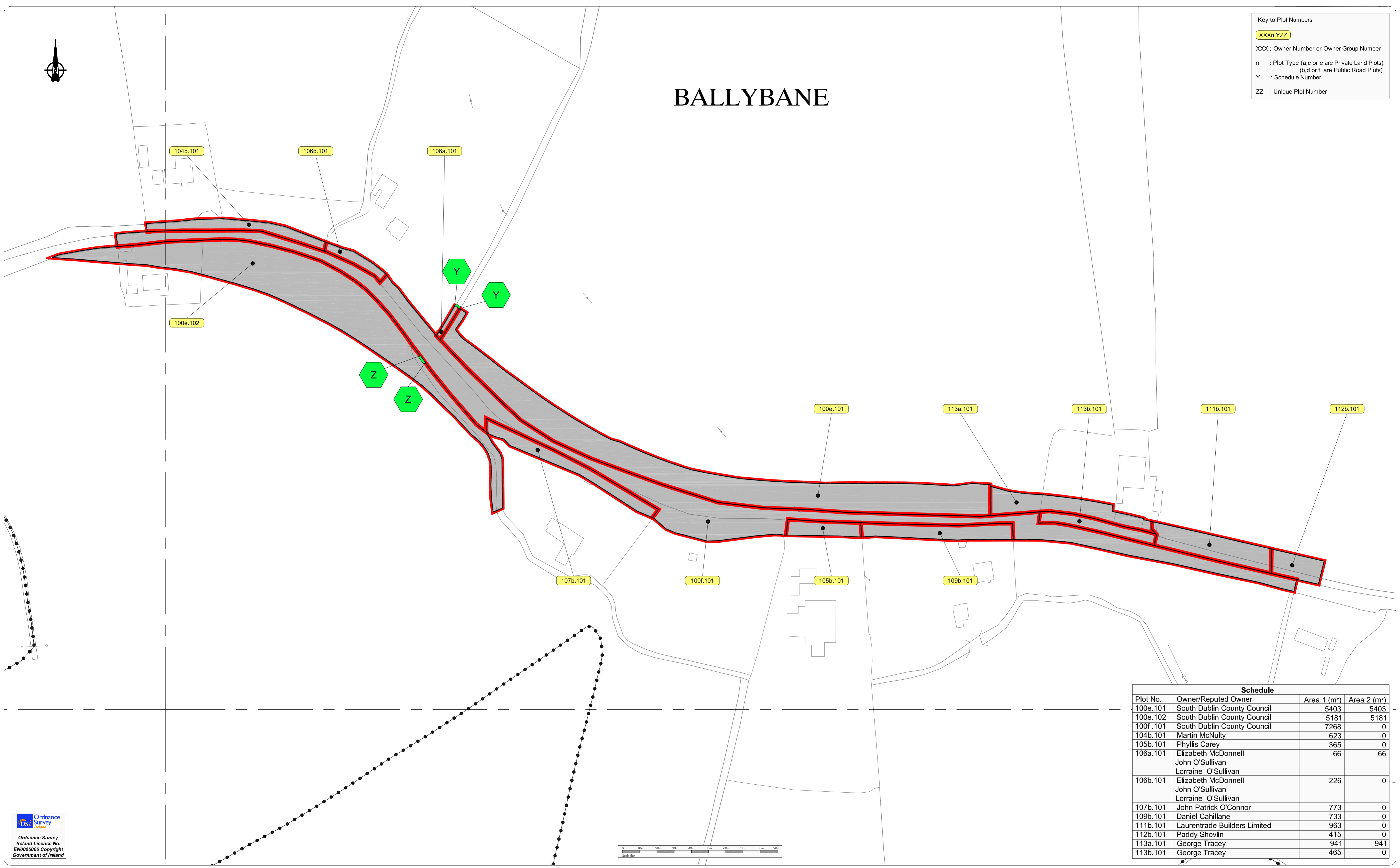

Schedule			
Plot No.	Owner/Reputed Owner	Area 1 (m ²)	Area 2 (m ²)
100e.101	South Dublin County Council	5403	5403
100e.102	South Dublin County Council	5181	5181
100f.101	South Dublin County Council	7268	0
104b.101	Martin McNulty	623	0
105b.101	Phyllis Carey	365	0
106a.101	Elizabeth McDonnell John O'Sullivan Lorraine O'Sullivan	66	66
106b.101	Elizabeth McDonnell John O'Sullivan Lorraine O'Sullivan	226	0
107b.101	John Patrick O'Connor	773	0
109b.101	Daniel Cahillane	733	0
111b.101	Laurenttrade Builders Limited	963	0
112b.101	Paddy Shovlin	415	0
113a.101	George Tracey	941	941
113b.101	George Tracey	465	0



COMHAIRLE CHONTAE ÁTHA CLIATH THEAS
SOUTH DUBLIN COUNTY COUNCIL
 ROADS AND TRAFFIC DEPARTMENT,
 COUNTY HALL,
 TALLAGHT,
 DUBLIN 24.

F.G. COFFEY B.E., C. Eng., F.I.E.I.
 Director of Transportation and County Engineer

J.F. McLoughlin B.E., C. Eng., F.I.E.I.
 Senior Engineer Road Design and Construction

Mayor / Deputy Mayor /
 Nominated Employee

County Manager

Director of
 Economic Development

Director of Transportation
 & County Engineer

Director of Planning

SOUTH DUBLIN COUNTY COUNCIL
COMPULSORY PURCHASE

(Nangor Road Improvement Scheme)
ORDER 2006

DATE
 November 2004

SCALE
 1:1000

DRAWN BY
 RPS-MCOS-JBR

CHECKED BY
 RPS-MCOS-PJM

APPROVED BY

Area 1 = Gross Area of Plot
 Area 2 = Nett Area of Plot
 Excluding Road Area

O.S. MAP REFERENCE
 3325 - 09, 3325 - 10
 3325 - 14, 3325 - 15

DRAWING NO.
MDT0161DP0003
Sheet 3 of 3