

SECTION 4-4

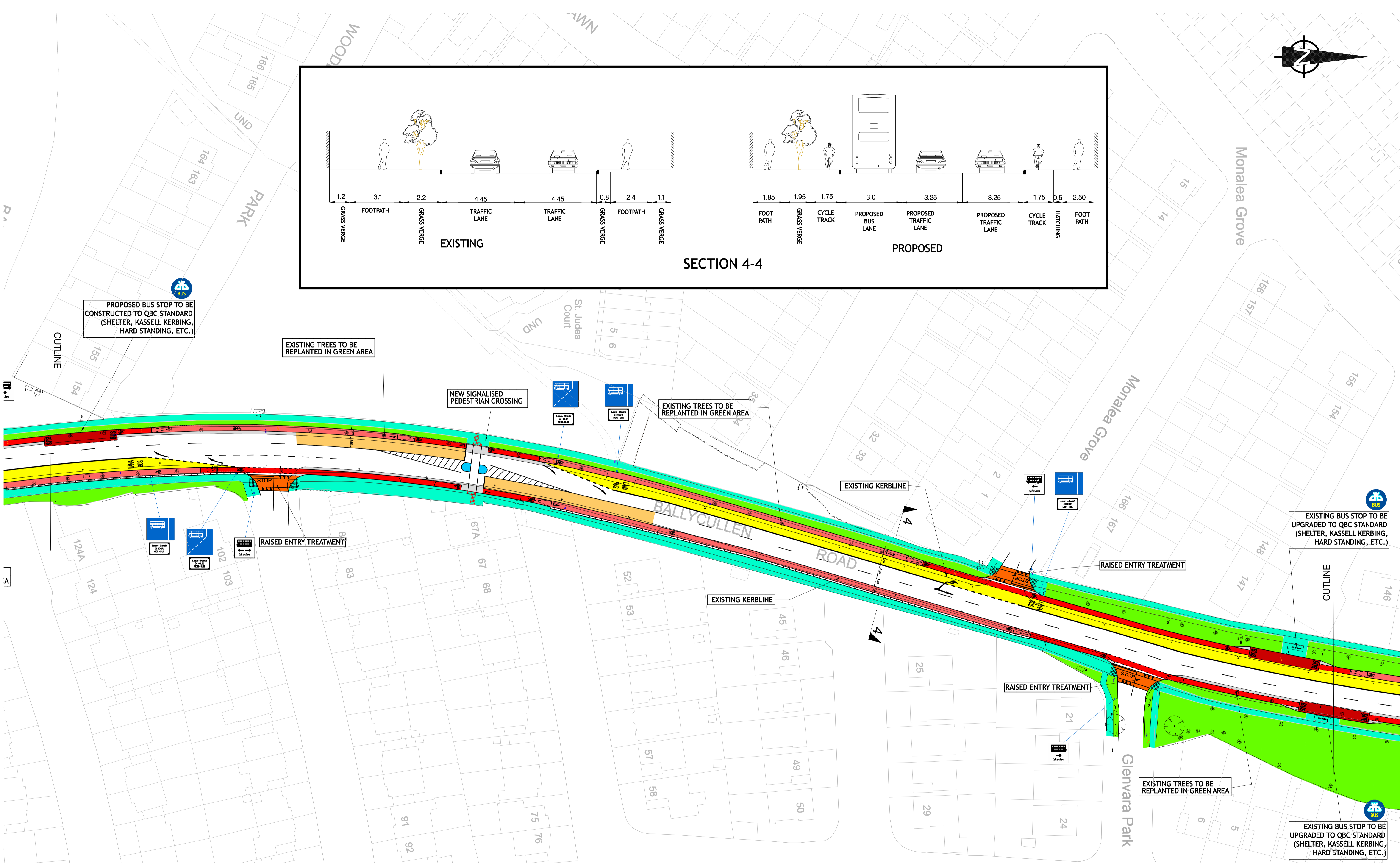

PROPOSED BUS STOP TO BE CONSTRUCTED TO QBC STANDARD (SHELTER, KASSELL KERBING, HARD STANDING, ETC.)

EXISTING TREES TO BE REPLANTED IN GREEN AREA

NEW SIGNALISED PEDESTRIAN CROSSING

EXISTING TREES TO BE REPLANTED IN GREEN AREA

EXISTING KERBLINE

RAISED ENTRY TREATMENT

RAISED ENTRY TREATMENT

EXISTING BUS STOP TO BE UPGRADED TO QBC STANDARD (SHELTER, KASSELL KERBING, HARD STANDING, ETC.)

EXISTING KERBLINE

RAISED ENTRY TREATMENT

EXISTING TREES TO BE REPLANTED IN GREEN AREA

EXISTING BUS STOP TO BE UPGRADED TO QBC STANDARD (SHELTER, KASSELL KERBING, HARD STANDING, ETC.)

QUALITY BUS NETWORK PROJECT OFFICE
 Oifig Thionscadal an Ghréasán Bus
 WorldCOM BUILDING
 4th Floor,
 Lower Erne Street,
 Dublin 2.
 Tel: + 353 (1) 6860100
 Fax: +353 (1) 6860127
 e-mail: qbnoffice@dublincity.ie
 Web: www.dublincity.ie

F. COFFEY
 DIRECTOR OF TRANSPORTATION & COUNTY ENGINEER, SOUTH DUBLIN COUNTY COUNCIL
 C. de BURCA Chartered Engineer
 PROJECT MANAGER, QBN PROJECT OFFICE

NDP
 NATIONAL DEVELOPMENT PLAN

dto
 Dublin Transportation Office

- BUS LANE
- CYCLE TRACK OFF ROAD
- CYCLE TRACK ON ROAD
- CARRIAGEWAY WIDENING
- BUS STOP
- FOOTPATH
- PEDESTRIAN ISLANDS
- ANTISKID SURFACING
- GRASS AREA

NOTE
 SUB STANDARD FOOTPATHS TO BE UPGRADED

No.	Revision	Date	By	Chk'd	App'd
	Stage				
	PRELIMINARY				
	APPROVAL				
	TENDER				
	CONSTRUCTION				

Project Title			
FIRHOUSE /BALLYCULLEN QBC			
Drawing Title			
PROPOSED ROAD WIDENING AND ROAD MARKINGS			
Designed:	CAD File: T_OBN_404_DPD	Sheet	OPTION 1
Drawn: KMC	Job No: T_OBN_404	4 OF 11	
Checked: ABK	Scale: 1-500 @ A1	Drawing No:	
Approved: AG	Date: JULY 2007	T_OBN_404_DPD-004	Rev: