

LEGEND

ROAD PAVEMENT	
FOOTPATH AND PAVED AREAS	
ON-ROAD CYCLE TRACK	
RAISED ADJACENT CYCLE TRACK	
OFF-ROAD CYCLE TRACK	
RAISED RAMP	
LANDSCAPED VERGE	

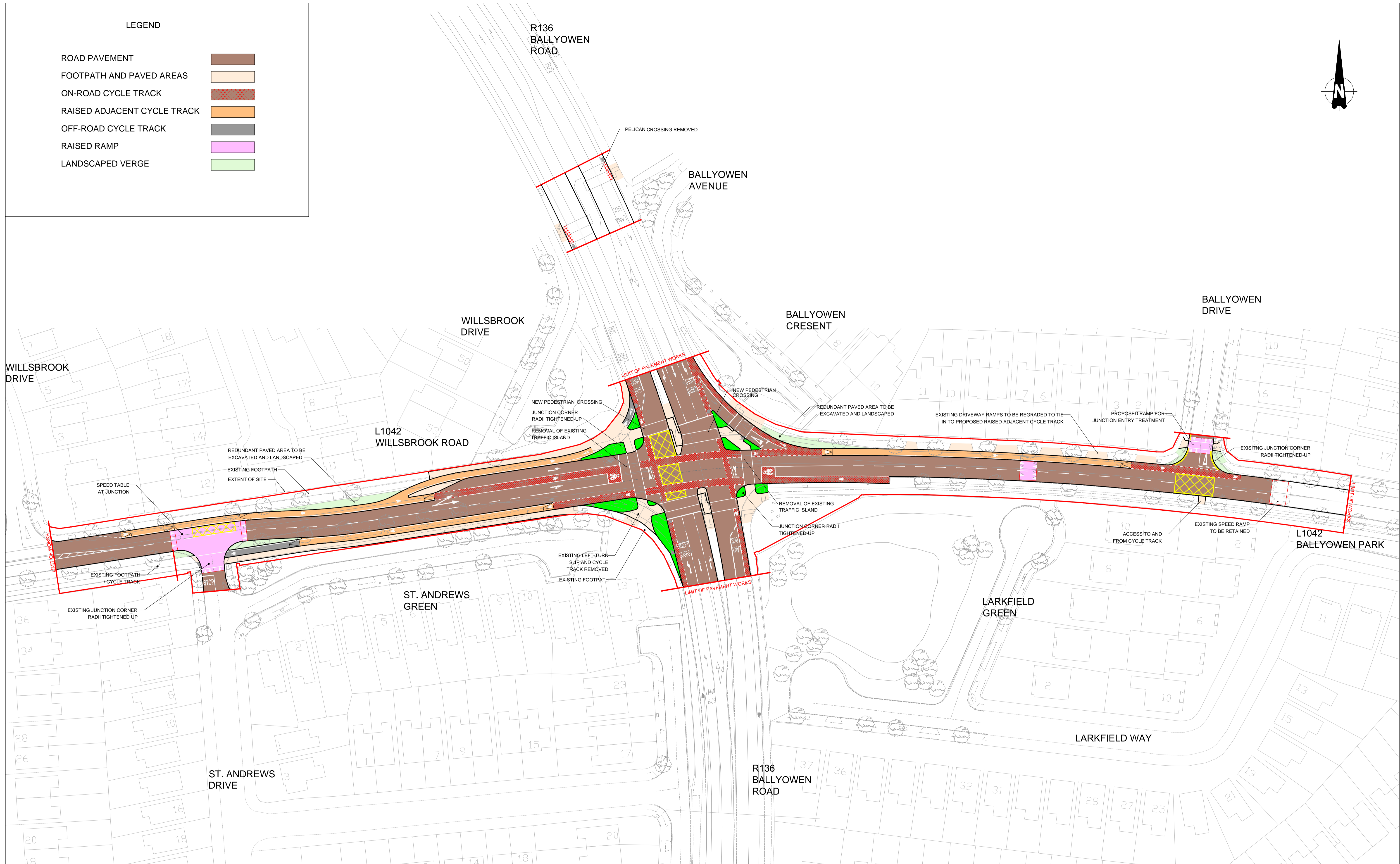
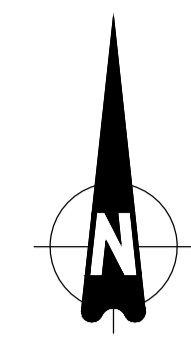

- NOTES**
- For setting out refer to Engineer's drawings.
 - This drawing to be read in conjunction with all other Engineering drawings and all other relevant drawings and Specifications.
 - DO NOT SCALE THIS DRAWING. Use figured dimensions only.
 - No part of this document may be reproduced or transmitted in any form or stored in any retrieval system of any nature without the written permission of O'Connor Sutton Cronin as copyright holder except as agreed for use on the project for which the document was originally issued.
 - Ordnance Survey of Ireland licence no. EN0000814 © Government of Ireland

Rev. No.	Date	REVISION NOTE	Dim. By	Chk. By
A	30/05/16	CONSTRUCTION	TD	AH
B	26/09/16	GENERAL REVISIONS	TD	AH



Land Use, Planning and Transportation
 Roads Design and Construction Section,
 County Hall, Tallaght, Dublin 24.
 E. Taffee B.E., B.A., M.I.E.I., C.Eng.,
 Director of Land Use, Planning and Transportation.
 John Coughlan, Senior Engineer.

OCSC
 Multidisciplinary Consulting Engineers
 O'Connor Sutton Cronin & Associates Ltd.
 9 Prussia St., Dublin 7.
 TEL: +353 (0)1 8682000
 FAX: +353 (0)1 8682100
 www.ocsc.ie

Client	SOUTH DUBLIN COUNTY COUNCIL				
Project	WILLSBROOK ROAD CYCLE SCHEME - PHASE 3 PROPOSED CYCLE AND TRAFFIC CALMING SCHEME				
Title	PROPOSED SCHEME GENERAL ARRANGEMENT				
Drawn by	TD	Chk. by	AH	Appr. by	TH
Date	30/05/16	Scale	1:500 @ A1	Dwg. No.	S512 -SK16
				Revision	B

Office Locations | Dublin (Head Office) | London | Cork | Galway | Belfast | Warsaw | Bucharest | Moscow | Abu Dhabi | Libya |